

CLASS SCHEDULE

DATE _____

NAME _____ SCHOOL _____

ADDRESS _____

PERIOD	MON.	RM.	TUES.	RM.	WED.	RM.	THURS.	RM.	FRI.	RM.
1										
2										
3										
4										
5										
6										
7										
8										
9										

5/14/13

Heading out to Bates 1

No real A horizon on top

30 cm brown (mostly homogeneous but a little mottled)

30-50 - developed A (A_b)

60 - transitions to E horizon

80 - B_t horizon - orangey clay - sterile soil

Southern end of unit is more towards mound end, while northern side will have more fill
Bates 1 Unit

SW 361 R964 (NW 363 R964)
(NE 363 R965)
(SE 361 R965)

- although B_t refers to clay, the reality is there is not much clay → it is only a lot in comparison to the other soils

Remove A horizon first (but call Level 1)

In Mound Fill + 20 cm arbitrary levels

- arbitrary levels start at the highest point in the unit

String inside nails, no bawk

A_b - step surface, take out as 1 level → more than 20 split

- A to E horizon is gradual, hard to see

- if anything is on top of the surface, bag separately (laying flat on surface)

- start packing up/ending things at 3:30

(Bates)

combo lock - 1225

- shut off for gate → to left and up → up is off

(Lewis Guection)

Landowners

Gene Bates + Susy

Bates 2 - George Bates + Linda

Photograph of every level + profile of every level

Site Unit Level Facing & what picture of

- carefully collect any charcoal we find
- 1/2" screen for mound fill, generally
- flotation samples are by context decision

Equipment -

Toolboxes	Camera	Photoboard	First Aid Kit	Sheets	Radio
Shovels	Rake	Maps	Long tapes	Kneepads	Trash bags
Split spoon	Loppers	Paperwork	Tripod		
Total station	Gloves	Notebooks	Buckets		

Bags → Bag # in corner
Site
Unit
Level
Date
Initials (3)

5/15
Started unit 361 R964

- Had Ben dig thru A horizon - very shallow due to trees & shade (went down ~5 cm to make sure that all possible modern contamination is gone. Casha + Emily were screening, but no artifacts were recovered (just natural eofacts - wood & nuts). Soil is a 10 yr $3/3$ and very silty. This is coming down on the mound fill. Although this is generally a homogenous brown there is some mottling that is probably evidence of basket loading.

- Had Emily dig Level 2, which appears to be the mound fill. Mottling became more extensive - this seems to be evidence of basket loading as a method of building the mounds. Generally this oscillates between a darker brown soil that is lightly mottled, and a lighter orangey brown that is mottled with more gray silt. A small amount of artifacts were recovered from this level, including some subrounded pebbles (1-3 cm) and some small fragments of prehistoric pottery. For this level, Ben + Casha were screening.

5/16
Continuation of unit 361 R964

- Started out with Casha digging Level 3 → we have now switched to 30 cm levels in order to get through this fill. As we are going down, Ben, Emily, + Casha are switching on/off getting some darker basket loads, but no apparent buried surface (A₁). Some artifacts coming out - subrounded pebbles, debitage, and undecorated pottery. In this layer we also got 1 sizeable rim sherd of Anna-incised pottery, which is a good dating marker for the mound. Technically this is Plaquemine culture and dates from AD 1200-1350. Although Vin looked at it and thought the temper/paste actually looked like it was from an earlier period. NW corner of unit 4 has what appears to be a humus-rich basket load that "sprayed" out into the NE corner at an incline, and reach about 1/5 way through the unit. At the bottom of this level the soil in the NW corner became a lighter brown with a higher clay content. However, it is still quite loose and at the same angle as the dark basket load, so we are interpreting it as redeposited B₁. Towards the end of this level, we aren't finding artifacts anymore, although this may just be due to the vagaries of basket loading. Also, sent Casha over with Andy to start a unit on the N/NW side of the mound.
* took a charcoal sample from level 2 for possible AMS dating.

5/17 Muggy! + cloudy 361 R944

Back to Bates to immediately begin on a new level. Almost immediately below the light redeposited B₊ in NW corner was a dark layer again, although at the time it was not clear if it extended across the whole unit. Ben dug ~5cm across the whole unit. Some pottery came out of this, as well as a thick piece of clear glass. It looks as though it is probably press or contact molded, maybe from a tumbler? This came out of the southern end of the unit, which is the shallow end. I then cut a window through the unit to give Ben + Emily an idea of the depth we are aiming for → the window is ~93 cm bd. While we are aiming for 98 cm bd, from this, it seems clear that there is a thin, ~1-2 cm thick buried A horizon → given the slope of the unit this is likely the darker soil we saw in the southern half of the unit. Below this is what appears to be more A₁, but we will see as we get the rest of the unit out. We will also take this down to the full 98 cm bd, which will give us a good idea ~~if~~ if this is correct. Below the A is a pretty clear

N. Wall Profile (not to scale)

E/B, so taking the unit down the full 30 cm level will get us ~4-5 cm into sterile

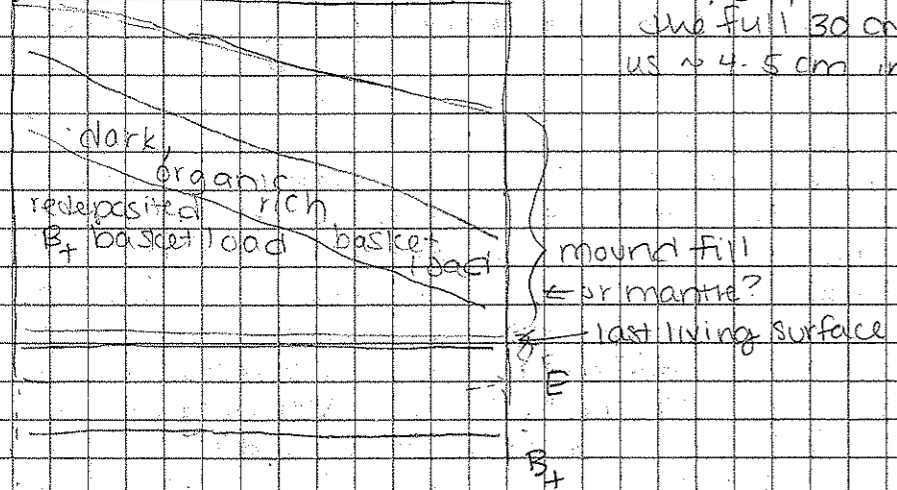

N. Wall

In level 3, for artifacts, we have some undecorated sherds of pottery, some sub-rounded pebbles, + some debitage. One of these appears to have a worked edge → perhaps a thumb scraper

5/20 381 R948

For today we switch things up a bit. 361 R944 is all done except for profiling the walls. We brought Mallory over to do the profiling, and then switched out the students for each wall. Ben did the first (N. wall), Cashen did the 2nd (W. wall), and Emily helped with the last two. We switched up what each student did for each profile (measure and draw). I then took over the 2nd unit on Bates I, 389 R948. We started at level 4 and just worked on a goal of getting one level done before lunch and one after. This level did not have a lot in it, but we did still recover pottery + debitage. The soil is relatively mottled and looks to have evidence of basket loading. We finished this level right before lunch (L.4) and took our photos after lunch. For the rest of the day we worked on level 5. The top of this level had some interesting basket loading patterns. This ~~got~~ came



drawn out to what we thought might be a buried A, but we were unsure b/c it was not a consistent depth across the unit. Instead it sloped to the south, and faded out to the west. We took out half the level (15cm) across the unit b/c of where we thought we saw the A in the soil probe, but the vagueness of the "A" left us very sad. However, we did note that a lot of material (relatively) began coming out once we got into this layer. This included a probable pot break (found in the screen)

of an undecorated pot with small lugs on the rim. We also found some debitage + pebbles, and took a charcoal sample. By the end of the day we had almost finished this level. Cleaning out the walls, we could see that we did have a buried A horizon, it was just not naturally level.

5/21 381 R948

Only Ben and I came out today to finish up the unit. Cashen and Emily went to Lessley mound. We had a little ways to go to finish the level. Due to the way the A₁ sloped into the SW corner, we took out a couple more cm in order to make sure that we were entirely beneath the A₁. Because of this slope, the North half of the unit is all the way into the B₊, while at the southern end we only got into the E in parts. The E here is still fairly brown and fades into the B₊. Then we had to work on artifacts / cleaning walls and taking photos, before chipping profile drawings. In level 3 we only found some debitage. While chipping back the walls, 2 pieces of pottery came directly out of the A₁, so we bagged them separately. One was undecorated, but the other

appears to be Anna Incised, which provides a nice, secure date for the mound as being ^{built} in the Playa emine period (AD 1200-1350). We only found one piece of shatter in the wall cleaning/cutting so this was bagged separately. Upon cleaning the walls, we could see a possible pit feature in the west wall. It seems to begin at the top of the buried A, although the top seems a bit deflated/sunken. It is filled with grey, silty soil. Other than all this, after photos, we spent the rest of our afternoon doing the profile walls, and finished up just in time for the end of the day.

West Wall Profile

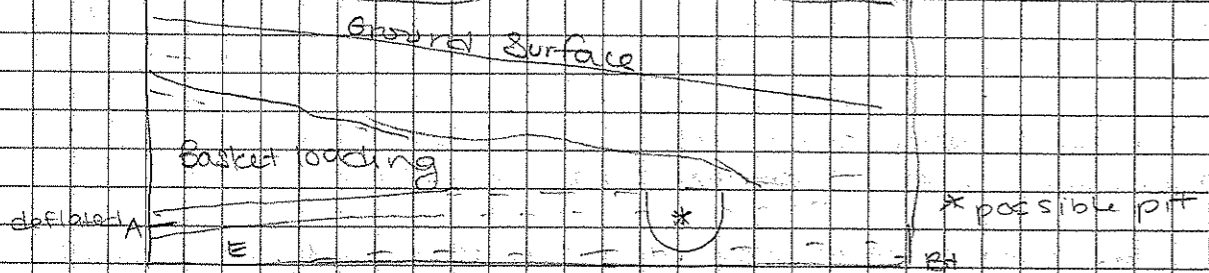

5/22 Wilkinson County 211R625
 off to Lessley mound. This mound is rectangular and pretty steep - doesn't appear to have been plowed. There is a family graveyard on the top of the mound, dating to roughly the 1830s, 1840s, although there are more recent burials as well. There are also unmarked burials around the base of the mound, mainly on the N/NW flank. These are visible by sunken in shafts and probably were the slaves of the family buried on top. As a result, the units have been placed somewhat more on the mound slope to try to ensure we don't hit any burials. Andy + Steven are on the N/NW flank of the mound in 211R625. This unit has a fairly steep slope to it. It was started yesterday, before I came over. They took off the topsoil/A (15 cm) and got through Level 2 into the mound fill. Apparently this produced a large # of pottery sherds in the A horizon, likely due to erosion off the top/sides of the mound. A Mazique Mazique sherd was found in this 1st level, but there was also pearl + whiteware in this, so it is unclear how reliable this is to date anything. The 2nd level, which goes into mound fill, so far does not appear to contain anything diagnostic, although this may change when things are washed. The # of sherds went down as well.

Today we started out in the 3rd level, which is still mound fill. Due to the rains last night everything is very wet, which is making digging and screening somewhat difficult. We have found a moderate amount of sherds, along with some debitage and pebbles. Thus far all of them look undecorated.

but again, this could change when things are washed. We are keeping baulks in the corners of these units because the soil doesn't seem as stable, which is also helped with the wet soils. We are also giving ourselves a little bit of leeway on the walls to make sure there aren't any collapses.

After lunch we worked on getting through level 4. The first half of this level had more artifacts in it, as well as a piece of probable pearlware in the western end. This end is also much shallower, so it may still be mixed historic/prehistoric fill. We got through the whole level before we had to leave at the end of the day. The second half of the level did not have as many artifacts and seems to be somewhat cleaner mound fill.

5/23

Myself, Steven, Kelly E at one unit 211 R625
 Mallory, Casson, Kelly W at the other unit 197 R625

Soils still seem somewhat wet from the rains 2 nights ago. We switched off who was digging in order to get the level down. By lunch we were basically down but still definitely in layers/lenses of mound fill. Occasionally there are some bigger pieces of ceramic coming up, along with some debitage. Ten dirty to tell if there is decoration on them. After lunch I jumped in the unit to clear back the walls and get the floor levelled. After that I had Kelly + Steven clean the walls and clean trowel the floor. We took our photos and then got a start on the next level (Level 6). Mallory + crew got down almost to their level and found the buried A (105 cm). They spent the rest of afternoon cutting back their walls and clean trowelling. They were almost done at the end of the day. There do appear to be some possible features at the top of the buried A.

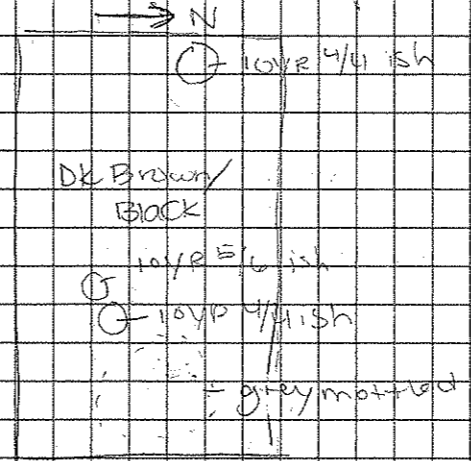

DK Brown/Black

10yr 5/6 ish

10yr 4/4 ish

grey mottled

5/24

Came back today with Steven Kelly E., and Morgan, and Kelly finish clean travelling the buried A horizon, once that was done we took photos and I had her do a nice plan map of the possible features in the A_b. We switched to 1/4" screen and I sent Morgan over to help since we just have 1/4" screen. In my unit (211 R625) I found the A_b in a window (1152 cmbd) to give the students a level to aim for. We then just worked on getting everything down to the A_b, which we got to basically right before lunch. Long lunch break while we talked to the landowner, Bobby West. In Kelly's unit, it is slow going because it is difficult to get the A_b through the screen. (196 R Back in my unit after cutting back the walls a little bit, I let Steve in to do the wall/floor cleaning for photo taking. After lunch, Kelly and Morgan worked on continuing to take out the A_b. Steven and I got the whole unit down to the buried A and I cut back the walls. Gave Steven the wall and floor cleaning and that took until the end of the day → but we did get our photos in. Although the unit is leveled, there is a swath of light brown soil in the southern part of the unit. I suspect this is just a slightly low spot and will travel away.

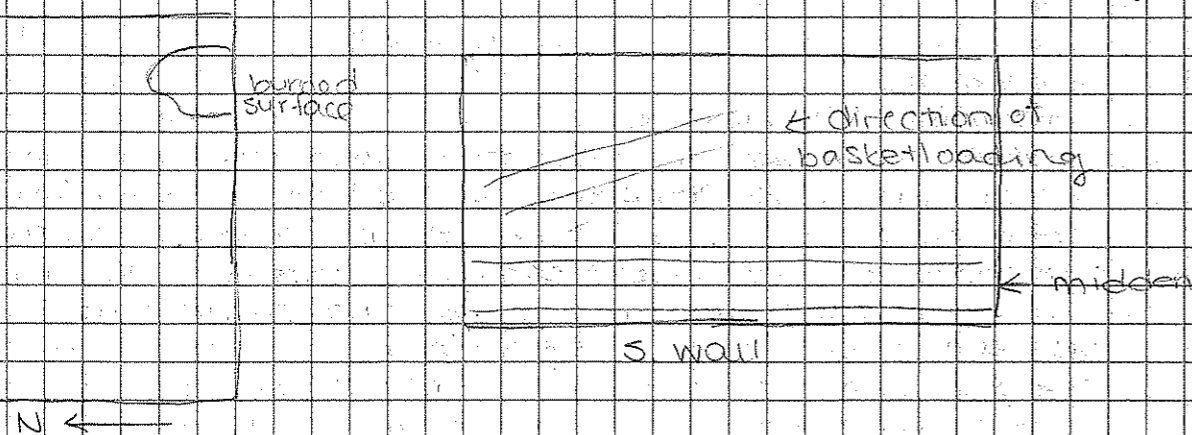

5/28 (211 R625)

Worked at getting the buried A horizon out today with Cashen and Steven. A lot of material was coming out of the buried A → lots of pottery, fired earth and some debitage. Some of it will definitely be diagnostic → I saw one piece that looked like Nazique <<<<, and another that may be Plaquemine brushed. This would indicate that the pre-mound occupation is the same time period as the rest of the mound. Additionally, the thickness of the buried A and the amount of midden seems to indicate that it is a midden. At the base of the midden, in the SE quad, we uncovered what appears to be a burned surface → it is pretty discrete and made up of burned earth. One corner is missing - probably

got nicked by the shovel before we knew it was there, but the soil directly beneath it also looks reddered. We got the level down to the E horizon and then worked on cutting back the walls. The unit on the opposite side (197 R633), they finished getting through the buried A and then spent the rest of the day cleaning the walls and floor although they weren't able to quite be photo ready. There do not appear to be any features in the bottom of their unit, although there is some light mottling in the west wall which appears to be from an old animal burrow (this is also in the wall).

Bobby West dropped off Powerades, soda, and some ice in the morning and we talked to him briefly at the end of the day when we brought his cooler back.

5/29 units open: 211 R625
197 R633

Came to the site today with Cashen, Mallory, and Morgan to try and finish at least one unit. John O'hear came in the morning to look at units, walls, and our feature. This was great, but also made things a little slow in 211 R625. About midway through the morning Morgan and Mallory finished cutting back their west wall, and I retook the photos. Then they started in on profiling (197 R633). In our unit, we talked with John about how to treat the feature. We decided to clean off the feature as well as cleaning back half the unit for a photo of the feature. After this was done we went to lunch. During lunch it started raining, so we closed everything up and finished eating up at Bobby's. Then we went to the clubhouse for cell phone reception so we could look at the radar. At that point, we didn't see any big cells coming our way so we thought it was safe to open up everything again. How silly. Right after we started reopening it, Meg came to the site with the generator and shop vac. We finished up the last of the cleaning and got photos taken of the feature, as well as getting it drawn in on plan view. Meg went over to the other unit (197 R633) to help with profiling, and almost immediately thereafter the skies opened up on us. We got completely drenched and left the site early, ~ 2:00 pm.

5/30 Units open: 211 R625, 197 R633

Just Cashen and I came to the site today. We finished up the last bit of profiling in 197 R633. That unit does not have much in the way of obvious basket loading, but there is a thin layer of slope wash above the buried A horizon, they are also closer to the top of the mound → this unit seems to be at less of a slope. After finishing the profile, John got here and we discussed the burned feature. We will bisect it, against the wall in order to get our nice profile drawing. At this point, after getting all of our measurements, we started taking feature 1 out. John had us cut it

back in thick chunks to try and get some thick pieces. Once we had the feature out, we need to level off the bottom of the unit. Due to yesterday's rain, we had to take off a good couple of centimeters to get all the gunk and trampled down stuff out. While getting this out, one and probably 2 postholes appeared in the floor.

After which we started cleaning the walls to get final photos done. At 6:30 we got the 30% chance of rain, hard enough that we had to cover up the unit. Because we were leaving early for the Windsor Ruins talk, at that point I decided it would just be better to leave.

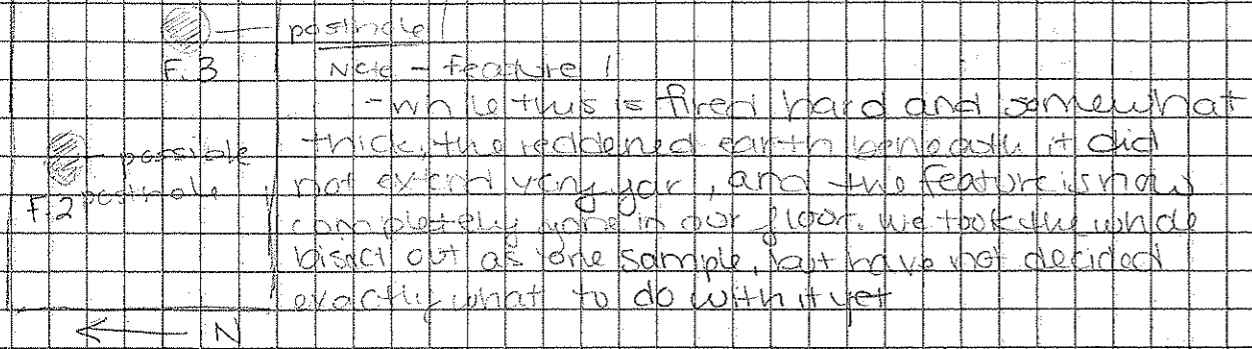

5/31 Units open: all REAS
w/cashed
-uncovered the unit this morning and finished cleaning the last wall. After this, we are cleaning the floor of the unit, and then we will be able to take pictures. After clean travelling we took pictures of everything - the floor pictures showing the 2 postholes came out really nicely. Starting at 10:30 we began profiling walls, starting with the South wall due to its complicated stratigraphy. It looks like there are basket-loads going in the opposite direction of the mound slope. Feature also shows very well in this wall. We finished the 1st 2 walls and then ate lunch, then finished the last 2 walls after lunch. No huge surprises.

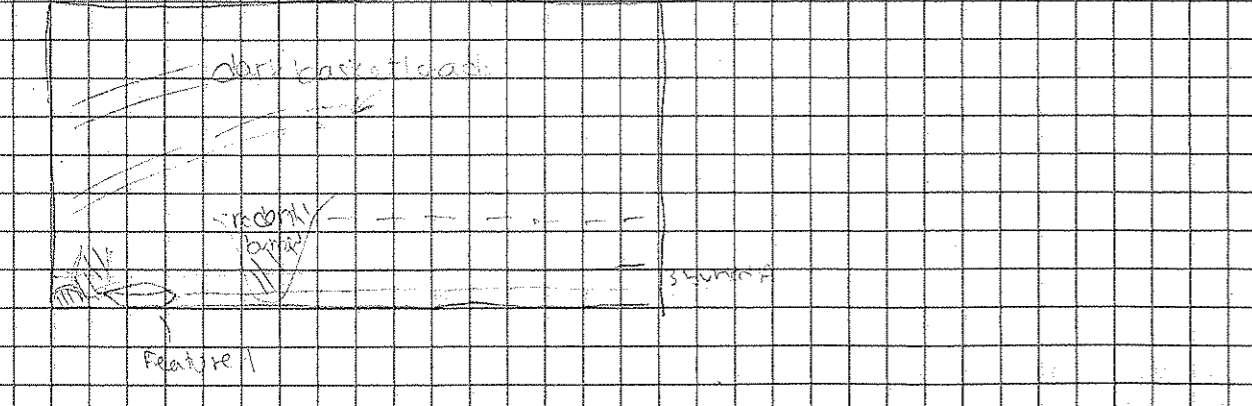

Features 2 & 3
- once we were done with the unit, we turned to the 2 features which appear to be postholes. Both features were bisected with a window taken out first and just the feature taken out in the 2nd half. For feature 2, given its location in the unit, I took out the South bisect/window first, and the N 1/2 of the unit next. This definitely looks like a posthole, and has a smaller zone of dark soil at the bottom. We took both bisects out as flotation samples. Feature was almost a perfect circle (~22cm) and extended 16cm into the subsoil. Feature 3 I had cashen take out. It followed the same procedure but due to location we took out the N 1/2 window first, and the S 1/2 second. We took pictures and drew profiles of both bisects. Visually neither appeared to have any artifacts, but perhaps flotation will tell a different story.

All in all, this was an extremely long day, and it was 6:30 when we finally got home, but we got everything done at Lossley.

6/3 Bayou Pierre Mound A 254 R491 Kelly + Ben

First day out at Bayou Pierre. Taking over unit 254 R491 at Mound A. Looks like they didn't have a camera with them because surface level 1, and level 2 we are releaning the base of level 2 to take a new photograph with the regular camera. Unit is on the North flank of the mound. Antelope/humans has been taken out, as well as 1.30 cm arbitrary level, which just came out of the southern half. We got through level 3 in the 1st half of the day. It contained debris, burned earth, Native ceramics, and historic. The historic mixed in are in pretty large pieces and don't appear to have been dragged in via plow. Towards the end of this level it began to look like we were in redeposited B₊ fill. Historic dropped off, as did other artifacts, at the same time, this stuff is very compact and a pain to screen. After lunch (documentation), we started on Level 4, which we almost finished by the end of the day. We did not find any historic in this level, but also only got a handful of Native ceramics and rocks.

6/4 Bayou Pierre Mound A 254 R491 Ben (Amanda)
Mound B 301 R486 Kelly + Kelly
301 R488 Joel + Cashen

Mound A - Finished up level 4, cleaned walls, & leveled off the unit. There does appear to be some dark soil showing up in the SW corner, but it is not clear that this is actually Buried A. Moved on to level 5. Had to leave Ben by himself a lot. So this level progressed slowly. From digging it appears that the dark spot in the SW corner ~~is~~ is a basketload on top of the A horizon, ~~it~~ it appears to have material in it. The rest of this level also appears to be more basketloaded, than compact redeposited B₊. A small area of dark basketload also appeared in the center on the East wall. We did get down to the top of the Buried A, which appears to be sloping. It is lighter and does not appear to be well developed. ~~down to the North.~~

Mound B

Units 301 R486 + 301 R488 are part of a 1x4 m trench on the almost gone Mound B. This was the beginning of the units. By the end of this day, both units were almost done with cleaning the buried A off. We recovered Native ceramics & debris, as well as historic material from the first level. Because we know this area has been disturbed via plowing the first level does all the way down to the buried A (we think not to take the historic off as a separate level).

-dark basketload

Mound A profile:

- Got started on this later than planned b/c work at Windsor w/ Amanda & Andy took a little longer than expected. When they got to B.P. I put Amanda with Ben and took Andy with me. We cleared off leaves et al. from the area where the profile trench will be and got it string. (It's 50 cm x 1 cm). Then we started clearing off overburden to try and get a look at the stratigraphy, but did not finish before the end of the day.

brown mound fill

6/5 Bayou Pierre

Mound A: 254 R491 Amanda, Ben, Emily
Mound B: 301 R486 Kelly, Kelly
301 R488 Malory, Steven
Mound A Profile: Me, Joel

Mound A: 254 R491

We thought we were at the top of the possible buried A and took our flat/waterscreen samples, then began screening this 1/4" screen. Partway through I came back to look at the unit b/c we couldn't decide if we were in Buried A or a dark layer of mound fill on top of the proposed Buried A. The SW corner had a definite yellow-brown patch that made it appear to be fill^{ish}. Although I would have rather taken a 2nd set of samples, we didn't have enough buckets to do so and even the cores were somewhat ambiguous. So my solution was to get rid of the original samples (they were screened) level the unit off at the bottom of the arbitrary level (130 cm) and to take new samples from the top of level 6. If there is a natural Buried A, this seemed the best method for getting samples from it. I am not necessarily convinced of this, however. The whole reason for using the arbitrary level as the stopping point was because we couldn't see any differentiation in the Oakfield b/t redeposited A and original A. I actually think the Bayou Pierre inhabitants stripped the original A here and then put down a dark A/middens layer as the first layer of construction here. Deeper cores did not appear to show anything beneath this besides a possible E or a B₊ with the samples cut. ~~We~~ are now 1/4" screening the possible buried A. Theoretically this will only be a few cm thick unless it dives elsewhere.

Mound B: 301R486 301R488

Started off the day with both units being clean
travelled for photos. Once this was done, samples were
taken. B/c we only had 2 1/4" screens for 3 units,
the 2 people at 301R488 ended up helping Kelly
& Kelly at 301R486. I left them with directions to
find the bottom of the buried A/top of the E, and
then get sandy into the E (~5cm) so we could look
for features. Something appears to have been lost in
translation b/c when I got a chance to come back
301R486 was being dug into what looked like the B+.
Upon seeing this (and a dark stain), I told them to
stop going any deeper and to level the unit off in
order to look for any features. There actually may
not be a super well-developed E but in profile I
thought it did look gray - will have to get more eyes on
this. The very weird thing is that there is A LOT
of material coming out, though it is not clear if this
is from only the "E" or also came out of the supposed
B+. I am told there were no ceramics coming out,
just lithics/fire-cracked rock. 301R488 does not have
all of the A taken out yet so we will make sure to isolate
what we think all the SE levels are to try and figure
out where artifacts are actually coming from. It is
also theoretically possible that the Buried A extends
farther than we thought -> although there was not
nearly as much material coming out of the Buried A
as there was from the "E".

Mound A Profile: Joel and I

- We started out by working our way up the mound
trying to get a view at the angle (without stepping).
Initially we could not identify a buried A so we cut
back a bit more, starting about halfway down the
mound. We did identify a distinct break b/w brown soil
& the yellow B+, but farther down the mound than I
had expected. This break is so clear (across the 3rd half),
that it does not appear to be natural -> it also looks
like the original A was cleared off and a new one
was laid down. At that point I decided to take the plunge
into stepping, cleaning the profile. Joel and I are doing our
best to get this nice and clean like a unit would be, but
it is difficult to do on such a steep slope. Cutting back
the walls, I did see a possible floor (gray colored) and
farther down, another floor or basket loading. It made it
to 3 -> 1/4 of the way down the mound that I had artifacts.

Bayou Pierre
(Not drawn to scale)

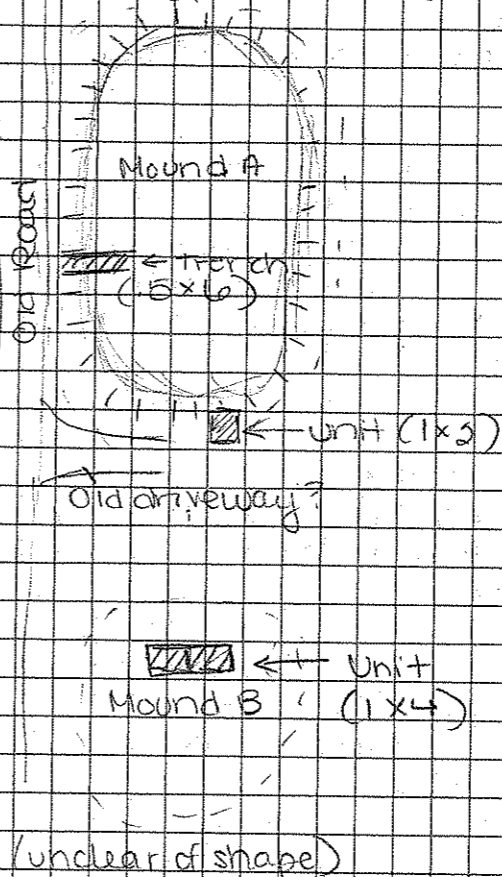

1/6 Bayou Pierre

Mound A: 354R491

Amaria & Emily

- Taking out the last of the A, which has to go through
1/4" screen. I checked on them throughout the day. Things
seemed to go fine, just slowly due to the consistency of the
"replaced" A. At the end of the day they had gone down
about 3cm into the E horizon, but needed to level things
out and clean shovel tomorrow. My sense is that there was
not a whole lot found in the replaced A besides stone/debris.

Mound B: 301R486 301R488

Me, Joel, David Kelly E

301R486

- This unit had to finish being cleaned - it is in the transitional
E/B+ zone and needed to be checked for features. Once clean
there was a small dark spot in the middle of the unit. We had
Kelly take this out as one - it was very shallow and came
to a point and we all agreed that it was probably just a root
stain. However, b/c there were allegedly still artifacts in this
soil, we called the level and started a new one as a double-check.
And it definitely did turn out to have artifacts in it -> all stone
debris, FR. (This was also 1/4" screened)

We got down to what we were sure was the B₁. There were still some artifacts here but we decided not to dig to steril. After this the unit just had to be cleaned and photo'd

301R488

This unit still needed some of the A taken out. This was 1/4" screened. We made sure we were through the A, did a few features, and called the level. Then we took out the E/B as one level down the same depth as 301R486. This also had a good amount of debitage as well as 1 large pottery sherd.

6/7 Bayou Pierre

Mound A: 301R491 Amanda + Emily

This unit is being levelled & clean trowelled. Floor went 5 cm into E and there did not appear to be any features. Once floor/wall cleaning was done I took photographs and left them to do wall profiles. Still don't participate. I think there is an intact buried A, or else it is almost the same color as what is immediately above it.

Mound B: 301R486, 301R488 Joel + Steven

We took photos for this unit the previous day so I came out and scribed in the morning. I am confused about the possible plowzone b/c there is so much mottling in areas that look like mound fill. Also didn't see any plow scars in the wall profiles. Perhaps there is another type of plowing that I am not used to that was used here? Either way I scribed the more mottled zones and told Joel + Steven to draw them in as dotted lines otherwise these profiles are fairly straightforward.

Mound A Trench: worked on cutting out the last few steps. As you get closer to the buried A it is much more rocky and there is one very large root from a nearby tree that we will need John's chainsaw to get out. Just had enough time to get the last 2 steps cut out but not cleaned before the end of the day.

6/10 Bayou Pierre

Mound A: 301R491 CLOSED

Mound B: 301R486, 301R488 CLOSED

Mound A Trench - Cashen + I

Worked with Cashen to get everything about this trench prepped up for eventual photos. Had her work on the last few steps (after the large roots were removed while I worked on the rest of it). Vin + John came by to look at the trench and to check the profiles of the other units. Jessam Crawford also came by with some guys from

The area who have done surveys with her before. Finished up the trench right before the end of the day and took 'last in case' photos.

6/11 Smith Creek

1049R597

- All of us, except lab people, were basically at Smith Creek today. I worked on the plaza unit with Andy + Steven, which started out at about 10 am. This has all been mission, all with some banding right above this level indicating that there are multiple fill episodes. Although there is bone here, it is very poorly preserved and immediately crumbles. What we do have here is plenty of ceramics. I think I got through a level or two today and they should be relatively close to the E horizon. When we re-foed the unit it looked like it was about a level away (which I got halfway through). Not much else to report on this unit.

6/12 Bayou Pierre

- Got instructions from Vin about how to set up the photomosaic rails and went out with Andy. Spent the morning re-clearing the trench, started taking photos during + after lunch. Once that was done, we spent the rest of the afternoon taking points on the trench. At last, I did some quick sketch maps and we mineralized layers.

Photos: West Wall Profiles, North Wall Profiles, South Wall Profiles, plan view profiles.

Points: Photomosaic rails, step by step.

Flank midden + buried A points, step by step.

Surface Level Points - North and South sides of Trench

Vin came by and took a closer look at the flank midden. In step 6 it is particularly thick and clearly contains charcoal, daub/fired clay, and ash. He decided that we should take the flank midden zone out of this step. He also took out a charcoal sample. Excavation of the step will take place tomorrow.

6/13 Bayou Pierre

- Came out with Vin, Emily, Ben, Steven. Big Larr and his friend were here with a bulldozer to clear the old road. Front loader is still not available. Vin took Ben + Emily over to help back-fill while Steven and I worked on the trench. Step 6 → first took out the little bit of brown mound fill over the flank midden in this step and then took photos. Then we took out the flank midden as 1 flotation bin and all the rest as water screen. There is appear to be a lot of charcoal, so we took two more samples. Didn't see much in the way of artifacts, but we did get some large pot sherds. Took picture at end of excavation.

Don't then grabbed larger pot shards out of wall. They all looked like they might have some residue on them. So they will not be washed in case we can test the residue.

- Both units at Mound A - Mound B were back-filled. Mound A Trench we got ready for backfilling. Plastic was laid down on the steps to protect them, and we piled sandbags up the back of all the steps. Ideally, we will have use of the front loader next week and can use that to aid in our backfilling. Either way it is ready to go. The plastic and sandbags are there to try and ~~get~~ guard against erosion (Oullie) when it rains.

Once this was finished we came back home and cleaned equipment / processed samples.

6/14 Smith Creek

Mound C 1077 R1627

- Myself, Kelly W, Steven, David, Morgan

- This was the unit with all the features, although they are below them now. Now it is inter-fingered deposits of light brown silt and black midden, many of which contain artifacts.

- Started out with Kelly W, Steven finishing out the hole. The level that was left. Lots of ceramics, some of which were not always in great shape. Halfway through the morning the unit was to be protected. Galoza unit and David came over to help us. We finished the level and then worked on straightening the walls. Found an awesome long nose sherd in the light brown fill that is thus far unique in terms of shape (round) and design. ~~It~~ ~~will~~ ~~find~~ ~~some~~ ~~more~~ ~~here~~ and ~~it~~ ~~will~~ ~~find~~ ~~some~~ ~~more~~ ~~here~~ and ~~it~~ ~~will~~ ~~find~~ ~~some~~ ~~more~~ ~~here~~. About half an hour after lunch David left to help with Mound A and sent Morgan over to help through about half the level before calling it a day (we left early to visit Mazique).

6/17 Windsor Mound D 307 R152

- This is a very low lying mound between (ish) Mound A and Mound C. It appears to have been plowed down over the years, although it may not have been that large to begin with. Kelly and I went out there to start it today. We cleared the top of the unit, string it took opening photos, and then got to work. Level 1 was the humus and plow zone (b/c it is soddy, and it is an open field, there really isn't a humus to speak of). We found a few ceramics and a piece of debitage in this. The transition to (mound) fill was very clear, as the plow zone was a homogeneous brown, while the fill was a mottled mix of colors. We finished the mound fill level 2, along with pictures and paperwork. All the junk in the mound fill was some debitage, river rocks, and a piece or 2 of ceramic. This level was clearly mound fill, as it was very mottled, but with no clear basketloading. It was also very compact - difficult to dig as well as to screen. It's unclear if this is a result of the plowing or not.

6/18 Windsor Mound D 307 R152

- Today started out as a rain day - at 7:15 Ben I rushed off to Windsor to get the unit more secure, as ~~it~~ it didn't have any plywood and the radar looked pretty nasty. We came back to the shelter and worked on waterscreening & flotation until lunch. At that point it looked like we were clear of rain for the day, so we went back out to Windsor. A little bit of water got into the unit, but it wasn't too bad. I dug while Ben screened. We started out in level 3, which is midden - soil beneath the plow zone. It was a very clear transition to this gray layer, which also had a very different texture than the fill above. We screened this through 1/4" screen, and even at the smaller size it went through much easier than the mound fill. Digging this layer, it also appeared to have a lot of insect activity going on. This turned out to be a pretty thin midden, although with a gradual transition to the E horizon it was somewhat ~~difficult~~ difficult to tell where that delineation was while digging. Despite using the 1/4" screen it does not appear there was much in this midden - even the ceramic we found was pretty small and not all that likely to be diagnostic. We switched back to half inch screen and continued to dig out the E horizon until we seemed safely under the midden and the mottling was reduced enough to see any possible features. We cleaned the walls in preparation for photos and mapping tomorrow, and that was the end of the day.

6/19 Windsor Mound D Ben + I 807R152
- Clean trowelled the walls and the unit floor and took our final photos, as well as mapped. Had some MNET visitors at lunchtime, as well as Vin. He looked at the unit and had us draw in the thin midden layer that was very gray. This was present mainly on the N/2 of the unit. I am calling it midden soil based on what it looked like at the top of Level 3 (gray, insect activity, glected w/daub), but it is possible some areas represent the original ground surface. Based on the stratigraphy, most if not all of the original ground surface was scraped away before the mound was built. We also took a soil sample from the very gray area to use for dating. The 2nd half of the day we back filled the unit and took equipment out. This was more of a task than it sounds like, as the rains made the path out to the site too muddy for the truck. We went over to Mound B with a half hour left in the day to see if we could help Andy + Maegan. They were just closing up their unit as they had come down on a possible floor in the unit. We helped fix the tarping to make it more secure and left for the day.

6/20 Windsor Mound B Maegan + I 80R316
This is a 1x1m unit on the summit of Mound B, a mound that is still in private hands. Although the mound has never officially been dug in, there do appear to be post-hole holes on the summit. Initially, excavation units were planned here. Augering around the base of the mound (done by Andy), indicated that there did not appear to be any intact buried ground surfaces, or even intact soils around the base. In a way, this was lucky, b/c we wouldn't have had time to dig 2 units there anyways. Augering at the summit seemed to indicate a hard burned surface 30cm below ground surface. Because of the time constraints, we decided to start this unit as a 1x1 and only expand it if time allowed. By the time we came back this morning, talking to Vin, Andy, Maegan, we had decided it was well past that they had come down upon this had been cleaned off essentially level, so we spent some time clearing the soil out to get a better picture of this. After clearing, taking

photos, Maegan and I mapped the daub (This is in Level 3). Then we began digging through it. We took a 10L flotation sample, as well as 2 water screen buckets. Because of the enormous amount of daub coming out of this unit, we just collected the 1/2 in screen material in buckets.

- While digging we came down on part of an intact prepared clay surface. We decided to stop Level 3 here, start Level 4, and call the floor Feature 1. There is a possible post hole in the floor, bisected by the E wall, that we called Feature 2. After documenting Feature 1, the floor we took it out separately as a water screen sample.

Beneath the floor, Feature 2 appears to continue. There is also clearly clearly more rubble beneath the floor. This was extremely loose and with very little if any soil within. Presumably this was from an earlier iteration of the building that was destroyed. The large amount of rubble were again collected in buckets. Some bone was apparent but there was not enough time to see what it was. The rubble mostly dissipated about halfway through the level (no other floor was apparent while digging) and the soil became ~~more~~ actual mound fill. There is still some daub in this, as well as remnants of burned log. Unfortunately, their outlines in the base of the Level were not particularly clear and they quickly trowelled away. By the end of the day, we finished Level 4 and did an initial clean of the walls. Although there did not appear to be much in the way of material other than daub, we were able to take a number of charcoal samples. This included a sample from within the daub rubble in Level 3, essentially on top of Floor 1, from the middened earth on the southern portion of the unit, from within the daub rubble in Level 4, and from the burned log (also Level 4). Just in the SE corner in the wall, there is the remnant of a second floor. Additionally, there is some sort of disturbance on the west wall going into the floor. It is circular but the stratigraphy of it in the wall is strange and doesn't really look like a posthole.

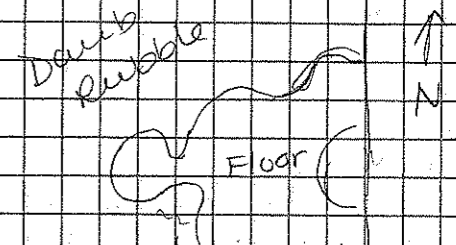

6/21 Windsor Mound B Morgan + J 80R316
- Finished cleaning the walls, which was difficult
to do due to all the daub rubble. Took final photos
then mapped the unit. Frankly, the stratigraphy
is very confusing, as the layers of daub rubble
and floors are only clear in some areas and
completely lost in others. Hopefully someone
can come back some day, open up a wider area,
and get a better sense of the buildings and
how they were oriented. While cleaning back the
East wall below the daub rubble + floors,
we found 1 piece of ceramic in the wall.
After finishing the mapping, we backfilled the
unit. David + Morgan came with some more dirt
archaeologists to finish the backfilling (Vin had
stopped by earlier and brought us hand-scraping
cloth strikers, and scissors, so we lined the
unit in case it is ever reopened). David also
brought the outer w/ extensions. We dug out
down about 3m and found 1 possible
surface ~130 cm (?) down, with everything
else homogeneous mound fill.

And that is all she wrote.